



Redmayne Arnold & Harris
estate agents, letting agents & surveyors

rah.co.uk



TO LET



58 Blackthorn Close, Cambridge, CB4 1FZ

£1,200 PCM



THE PROPERTY

A first floor unfurnished two bedroom apartment within this established residential development located within easy access of the City Centre, A14 and Science Park. The property comprises entrance hall, living/dining area, kitchen, two bedrooms and bathroom. There is also off-road parking available. The property is managed by RAH. Council Tax Band - C. EPC Rating C.

6/12 month tenancy
Deposit £1380

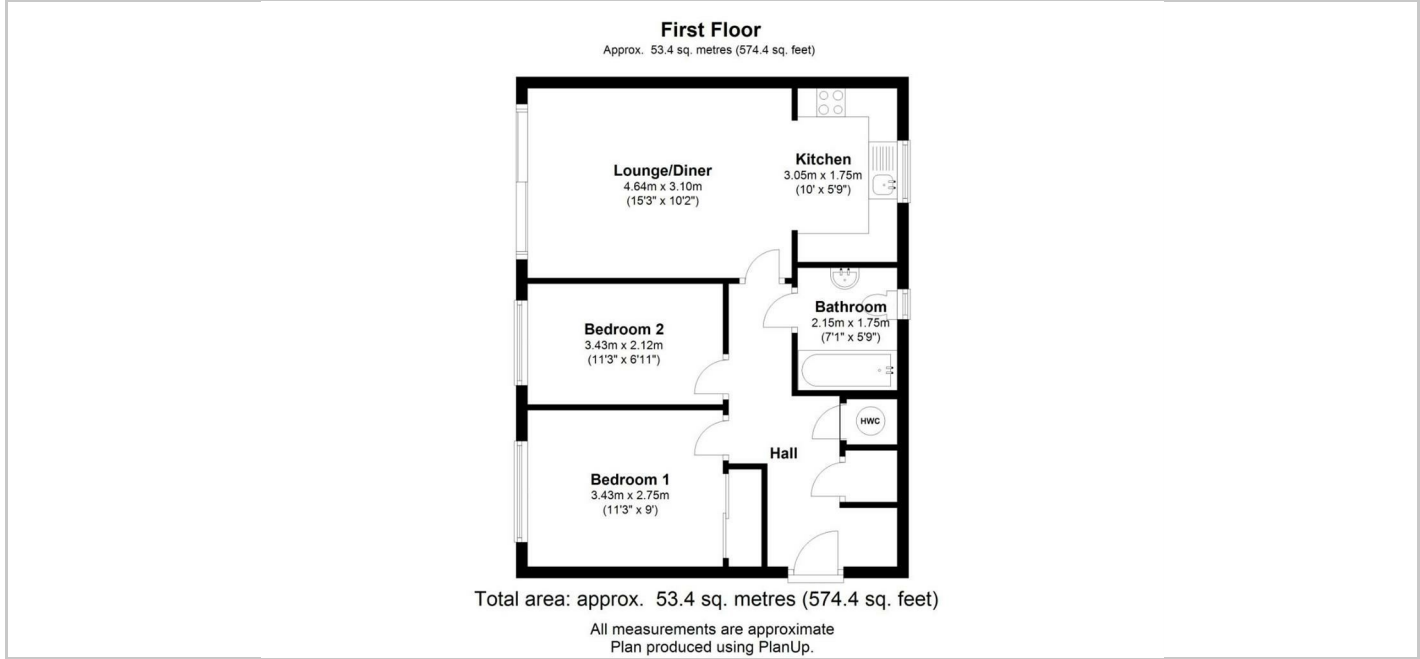

SITUATION

Directions

